

STONE SERIES INSTALLATION GUIDE

MODELS: S32WC-G13, S32WC-G18, S32WC-2G13, S32WL-G13, S32WL-G18, S32WL-2G13



If for some reason you are missing parts or have a problem with your fixture

DO NOT CALL OR RETURN TO THE RETAILER. Call for direct assistance at 1-877-870-9283.

PLEASE READ ALL INSTRUCTIONS CAREFULLY BEFORE INSTALLING FIXTURES.

BEFORE INSTALLATION

1. Please check to see that your fixture was not damaged during shipment, and that you received all the hardware needed for installation. While we strive for perfection, accidents do happen. If you have a problem or are missing any parts, please call us at 1-877-870-9283 immediately.
2. **CAUTION: Disconnect main power at the breaker box before beginning installation. Do not turn power off at the wall switch only. Failure to properly disconnect the main power supply may result in serious injury.**
3. **CAUTION:** Install the appropriate size lamp in your Stone fixture. Do not exceed the manufacturer's maximum wattage restrictions.
4. **SPECIAL NOTE:** For easier installation, it is recommended the two (2) people be used when making the electrical connections and mounting the fixture.

HARDWARE

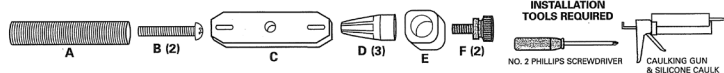

INSTALLATION



Disconnect main power supply at the breaker box. **DO NOT** turn power off at the wall switch only.

CAUTION: FAILURE TO DISCONNECT MAIN ELECTRICAL POWER MAY RESULT IN SERIOUS INJURY.

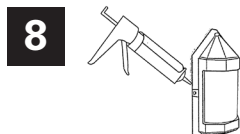
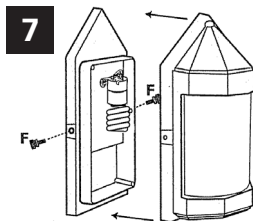
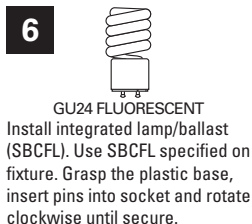
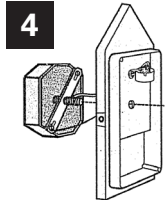
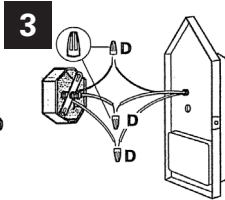
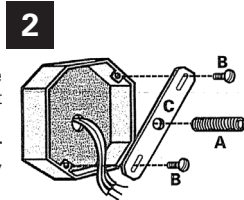

Apply silicone caulk completely around the fixture backplate for a watertight seal.

Customer Service 1-877-870-9283

www.wavelighting.com

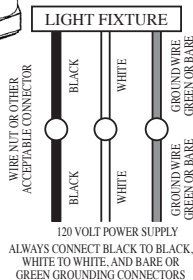

This fixture may have an integral photo sensor that turns the fixture off during the day and on at night. The photo sensor is not adjustable. The fixture could possibly cycle on and off due to light reflected from nearby surfaces into the photo sensor. If cycling occurs, remove the photo sensor nut and install the swivel hood and base.

The hood and base are adjustable. The hood can be rotated and the base can be cut along the dotted line to reduce overall length. Check operation before cutting the base.

BALLAST AND LAMP REPLACEMENT INSTRUCTIONS

Product contains an integrated Lamp/Ballast combination. To remove, grasp plastic area on each side of bulb area and rotate counterclockwise. Replace with MAX 32W SBCFL(GU-24) that is marked with the UL and C, US Logo. Use SBCFL marked - Not for use where directly exposed to water. Do not use SBCFL marked - Not for use in totally enclosed luminaire.

Mark means lamp contains Mercury. Follow disposal laws. See www.lamprecycle.org

